

buried uplighter, circular

Buried uplighter, circular (overlapping); accent spotlight with superspot beam pattern, approx. 6°; lamp(s): 7/2.5W (PowerLEDs with lens optic), ±15° tilt, light colour: daylight white (6,000K); power consumption 17.5W; includes control gear; mains voltage 220-240V 50/60Hz; power connection: 3-pole terminal strip; recessed housing: diecast aluminium, white powder-coated finish; PG cable gland; through-wiring possible; partially frosted glass cover; max. surface temperature of glass panel 40°C; stainless steel surround with Camlock catches (no screws visible); maximum load: 1,000kg pedestrian traffic; IP67 degree of protection, class of protection I; includes gasket to protect against water penetrating between luminaire unit and concrete casting surround; concrete casting surround kit must be used for installation in concrete floors or plaster (please order separately); floor cut-out for concrete casting surround, circular: Ø260mm, floor cut-out for installation in wooden and cavity floors, circular: Ø255mm, recessed depth: 214 mm; weight: 5.5 kg;

Please note: always use flexible leads e.g. H07RN-F when installing the luminaire; if fitted in elevated wooden floors or as downlight in ceiling panels, luminaire requires overlapping surround and installation kit for wooden and cavity floors (please order separately).



ZS_PAS_F_2_D260_7x2W_LED_WD_230V_SSP.jpg

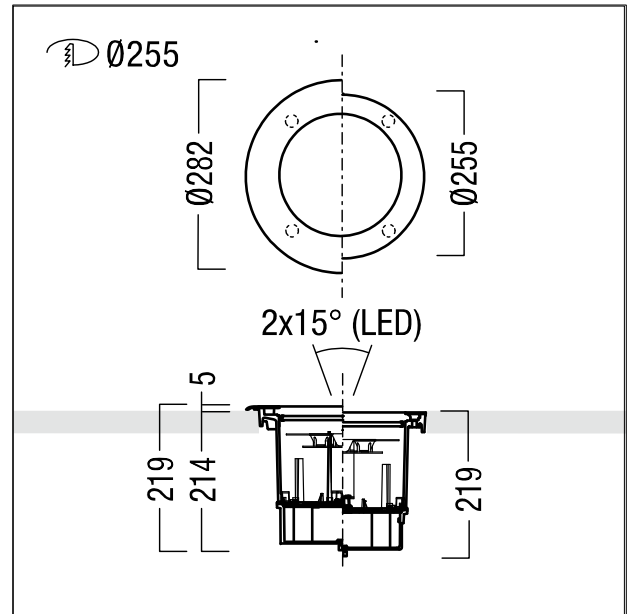

ZS_PAS_M_2_D260_LED.wmf

Light Distribution

STD - standard

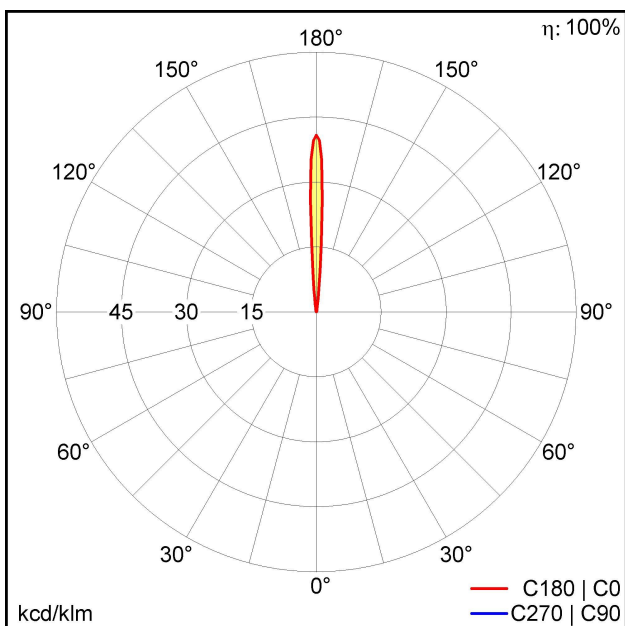

60813737_001.ltd

- Lamps: 7 x LED_161 / 2.5W
- Total luminous flux of luminaire: 1127 lm
- Luminaire efficacy: 64 lm/W
- Connected Load: 17.5 W
- Maintenance category: E - Dust-proof IP5X

Luminous flux and connected electrical load are subject to an initial tolerance of up to +/- 10%. Color temperature is subject to a tolerance of up to +/-150 Kelvin from the nominal value.